

# WORTLEY FOLK CLUB

## How to find: the Venue, Stocksbridge

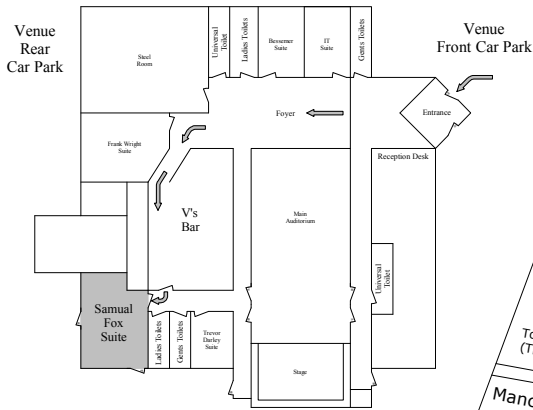

Layout of the Venue

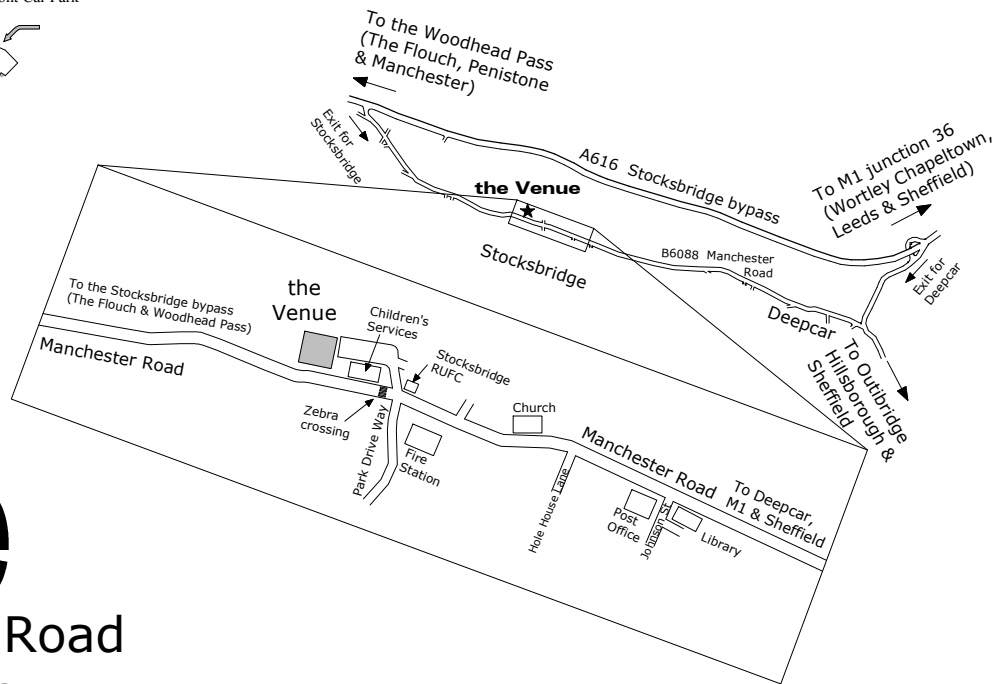

## the Venue

650 Manchester Road  
Stocksbridge

South Yorkshire S36 1DY

Tel: 0114 283 8692

Sat Nav users, enter postcode  
**S36 1DY**

### From Sheffield direction (and the M1):

Either use the A6102 from Hillsborough (Sheffield) or the A616 Stocksbridge Bypass from Wortley (M1 junction 35A or junction J36), leaving the bypass at the Deepcar exit. At the traffic lights at Deepcar, turn onto the B6088 towards Stocksbridge. Follow this road (Manchester Road) for about 1½ miles through Stocksbridge, passing (on your left) the Library and Post Office then, on the right, the church, then immediately after the Fire Station (on your left), turn Right down Park Drive Way. This right turn is immediately before the zebra crossing and between the new Children's Services building and the Stocksbridge Rugby Union FC clubhouse. A short way down this road, there is the car park with the Venue clearly visible on your left.

### From Manchester (and the West):

From the Manchester direction, take the A628 Woodhead Pass towards Sheffield, at the Flouch roundabout take the A616 towards Stocksbridge which becomes the Stocksbridge bypass. Turn right off the A616 Stocksbridge bypass following the signs for the B6088 Stocksbridge. Follow the B6088 into Stocksbridge for approximately 1 mile then, immediately after the zebra crossing turn left before the Stocksbridge Rugby Union FC clubhouse. A short way down this road, there is the car park with the Venue clearly visible on your left.

### Inside the Venue

After entering the automatic doors into the Venue, proceed straight down the foyer then bear left into the V's Bar. Proceed past the bar (collecting drinks if required) and the Samual Fox Suite is through the swing doors signed with the Wortley Folk Club logo.